

PIN TYPE	DIM. L. #0.10(.004)	PIN NUMBER
DETECT	3.50(.138)	36, 67
GENERAL	4.25(.167)	ALL OTHER PINS
POWER	5.00(.197)	1,17,34,35,51,68

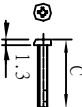

RECOMMENDED HOLE PATTERN

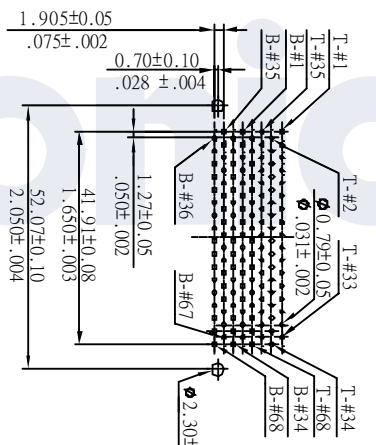
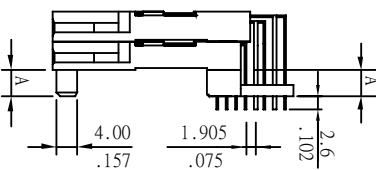
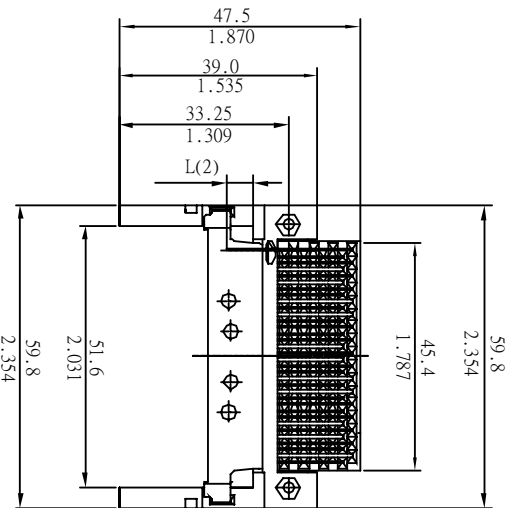
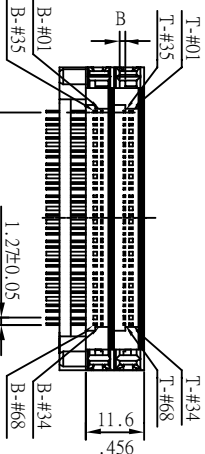

A	B	DIM B = 1.1mm	DIM B = 2.2mm	DIM C =
(D) Voltage 5V (V)	1279*TE*G00	1279*TE*G0V	16.3	
(F) A = 2.2 mm	1279*TE*H00	1279*TE*H0V	17.3	
(H) A = 3.0 mm	1279*TE*I00	1279*TE*I0V	18.3	
(J) A = 4.0 mm	1279*TE*J00	1279*TE*J0V	19.3	
(S) A = 5.5 mm	1279*TE*S00	1279*TE*S0V	19.3	

(1)

- Features:**
- * Material:
 - Insulator: UL 94V-0 LCP
 - Contact: Copper alloy
 - * Color: Black
 - * With 2 PCS M2 screws
 - * Accept PCMCIA Type I, Type II or Type III card

Ordering Information:

1279 * T * E * 0 * *

- Series No.
- D = Double stack(with logo)
- N = Double stack(without logo)
- T = Through hole
- E = Without guide
- Contact plating
- S = Selective gold flash over 40u " PdNi
- K = Selective 30u " gold over nickel
- F = Selective gold flash over nickel
- J = Selective 15u " gold over 50u " nickel
- An attached table (1) A
- Special options
- An attached table (1) B

REV.	EQ. NO.	CHK	APP.
A	DWG REL.		

LEDCO CORPORATION		APPROVED:	PART NO.:
GENERAL TOLERANCE	X ±	DATE:	1279*TE*0*
	X ± 0.30	CHECKED:	DOUBLE STACK PC CARD
	X ± 0.12	DATE:	DRAWING NO.:
	X ± 1°	DATE:	1279DCS
	X ± 0.20	DATE:	SCALE:
	X ± 0.08	DATE:	SIZE:
	X ± 0.1°	DATE:	NIBBET:
	X ± 0.1°	DATE:	REV.:
	X ± 0.1°	DATE:	A