

Addonics
TECHNOLOGIES

Quick Start



JASPER 11MSA Duplicator (JD11MSA)

www.addonics.com

Technical Support

If you need any assistance to get your unit functioning properly, please have your product information ready and contact Addonics Technical Support at:

Hours: 8:30 am - 6:00 pm PST

Phone: 408-453-6212

Email: <http://www.addonics.com/support/query/>

Contact Us

www.addonics.com

Phone: 408-573-8580

Fax: 408-573-8588

Email: <http://www.addonics.com/sales/query/>

Overview

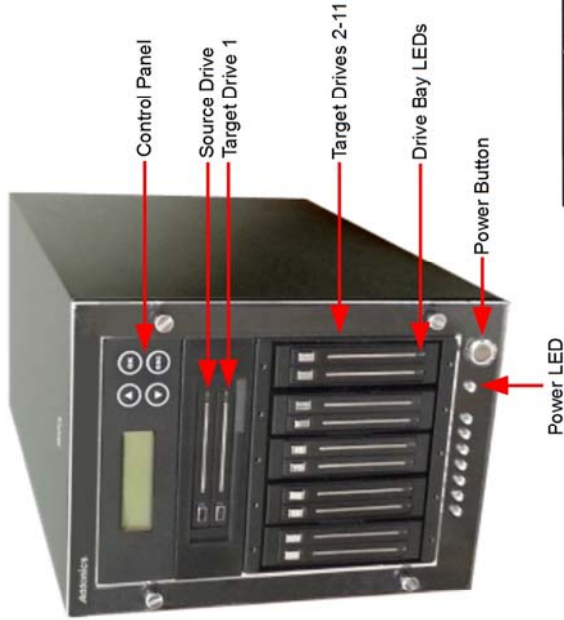

Drive Bay LEDs: Blue indicates power, flashing indicates activity. Steady amber glow indicates an error.

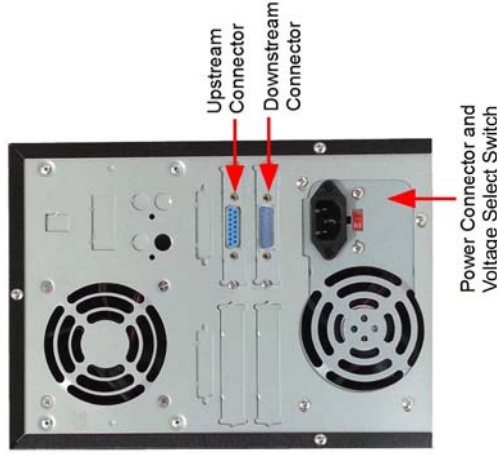

WARNING: Please remember to set the power supply to your local outlet voltage prior to plugging in the power cord. Failure to do so may damage the power supply.

Quick Start
By default, the duplicator will initialize, scan for drives and offer the copy function. Insert the source and target drives, power up the unit, wait for the copy function to appear, then press ENT. When finished, the unit will report how many targets pass or fail. If a target fails, the duplicator will cause a drive bay LED to glow amber. If the source drive causes a failure, ALL of the drive bay LEDs will glow amber.

Canceling Functions

When selecting menu options, canceling is done by pressing ESC. When the unit is busy performing an operation such as copy, verify, or overwrite, the operation can be canceled by holding the ESC button until the unit beeps.

Installing mSATA SSD into 2.5" mSATA adapter

Please reference to the diagram below

1. Slide your mSATA SSD connector side into mSATA connector on the adapter at ~ 30 degrees angle.
2. Push down the other end of the mSATA SSD till the media is latched down by the spring clip



Loading the 2.5" mSATA adapter into the duplicator

When loading into the horizontal drive bay, make sure the open side (or the media side) of the adapter is faced down.

When loading into the vertical drive bay, be sure the open side (or the media side) of the adapter is faced to the left.