

INTRODUCTION

The new family of Addonics Jasper II Duplicator is one the fastest and most advanced drive duplicators in the market.

High Performance

The Jasper II Duplicator can copy at a rate up to 260 MB/sec, more than twice the performance of most duplicators in the market. Whereas the performance of most duplicators declines with increasing load, the duplication speed on a Jasper II duplicator remains the same regardless of number of drives in the copying process.

Expandable

Unlike traditional duplicator that is designed for a fixed number of targets, the duplicating capacity of a Jasper II Duplicator can be expanded by connecting multiple units together. So if you have three Jasper II duplicators with 3 targets, 11 targets and 19 targets, you can connect all three together to turn them into a 1:35 duplicators. Or you can connect two 1:11 Jasper II duplicators together to form a 1:23 duplicator.

Flexibility

Since the Jasper II Duplicator can be connected together, different type of media can be easily mixed in the duplication. For example, a Jasper II 3.5" drive duplicator can be connected to a Jasper II 2.5" drive duplicator which then connect to a mSATA duplicator. In this set up, a 3.5" source drive can be copied onto 2.5 drive or mSATA card all at the same time. To use different media as the source, you would just need to move the appropriate type of Jasper II duplicator to the beginning of the chain. So instead of having the Jasper II 3.5" drive duplicator as the first duplicator in the chain, you can either move the Jasper II 2.5" duplicator or the Jasper II mSATA duplicator to be the first unit in chain.

About this model

This Jasper II 3M is a 1:3 high performance and expandable duplicator for M2 SATA SSD, mSATA SSD and 2.5" HDD/SSD. The duplicator makes copies from one to three (3) drives at one time with a mix of any of the supported drives at speed up to 260 MB/sec. Drives are loaded directly into the duplicator with no special tools required. Comes bundled with four (4) 2.5" M2/mSATA drive kits, either the M2 or mSATA SSD is loaded into the duplicator just like a standard 2.5" hard drive. By adding different optional 2.5" flash drive kits, this duplicator can also copy other flash cards such as CFast card, CF card, micro SATA drive or slim SATA drive.

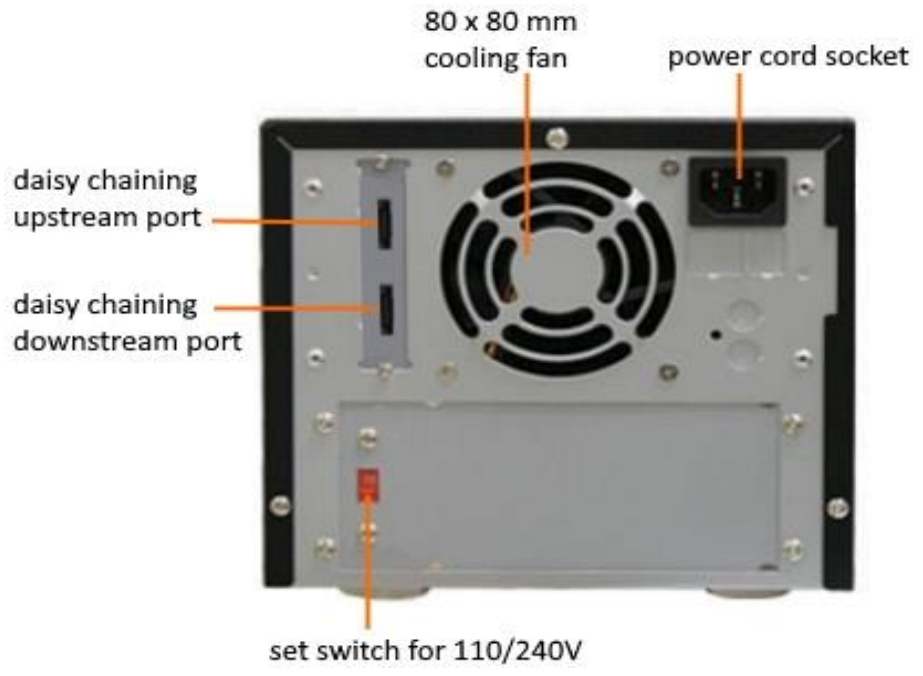
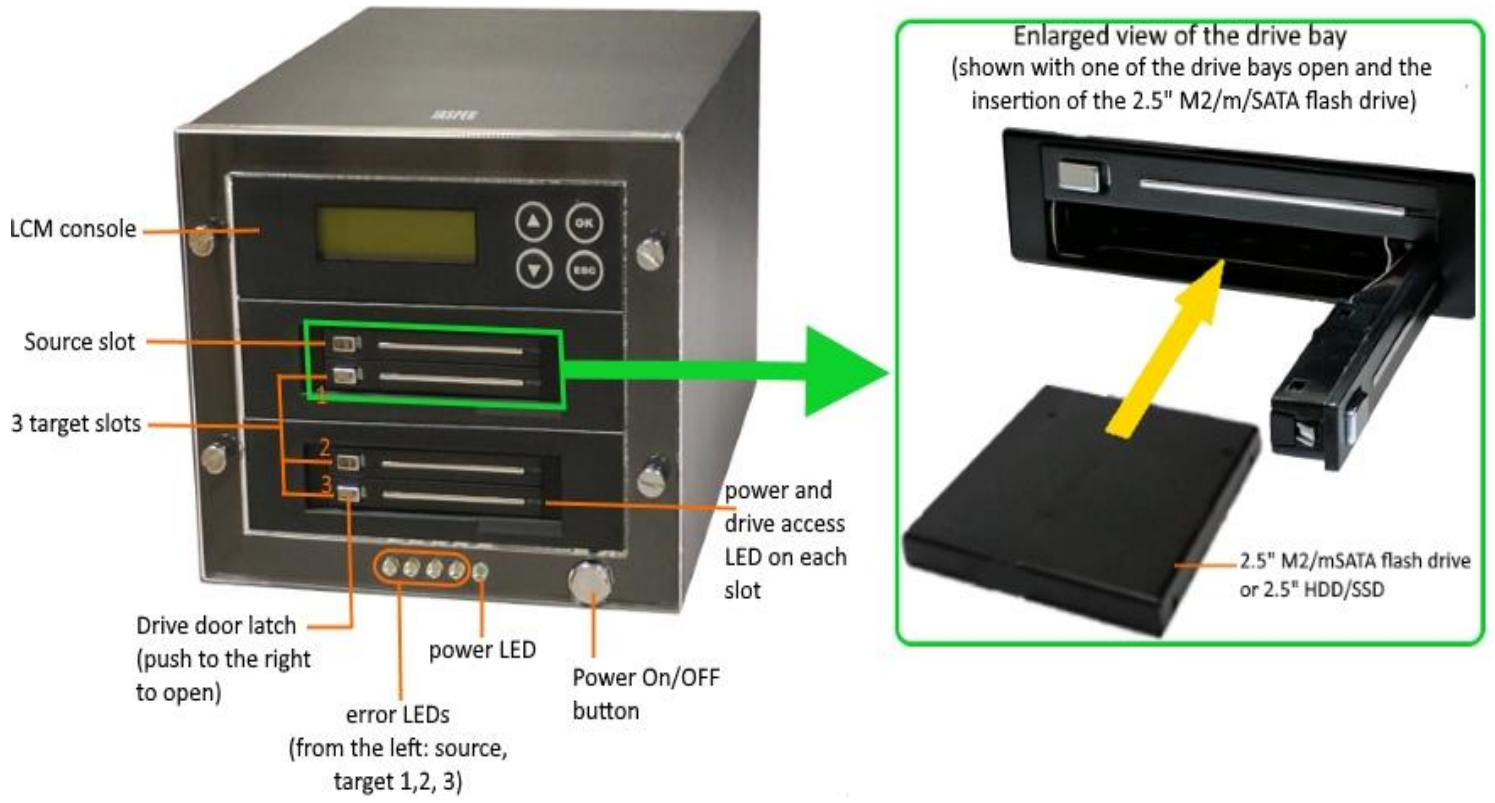

Installing the M2 SATA SSD onto the 2.5" M2/mSATA flash drive kit

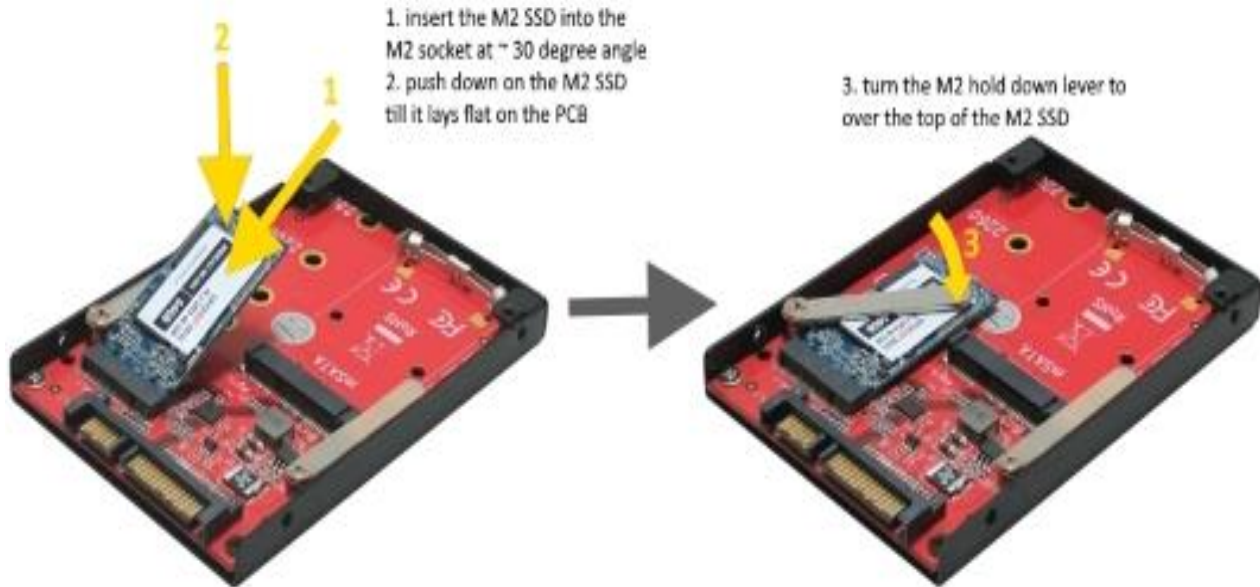

Installing the mSATA card onto the 2.5" M2/mSATA flash drive kit



FEATURES

- Duplicates up to three (3) M2 SATA SSD¹, mSATA SSD or 2.5" HDD/SSD at one time
- Great for cloning M2 SATA SSD, mSATA SSD or 2.5" HDD/SSD, system upgrade, transferring content among these drives or for data distribution
- Includes four (4) units M2/mSATA flash drive kits (AD25M2MSA) and one eSATA cable (AAESATA100C) for daisy chaining
- Supported media - M2 SATA SSD, mSATA SSD, 2.5" HDD/SSD
- High performance with no performance degradation regardless of number of targets
- Copying speed up to 260 MB/sec*, more than twice the speed of most duplicators in the market.

*Actual speed depends on performance of the media

- Multiple Jasper II duplicators can be connected together in a daisy chain to expand the number of targets up to 255 maximum
- Supports any type of file systems using sector to sector copy
- Can be set up to copy data only for the following supported file systems:
 - Windows FAT 16/32, exFAT, NTFS
 - Linux: Ext 2/3/4,
 - Mac: HFS/HFS/HFSX
- Maximum drive size >4TB
- Drive sanitizing:
 - Quick ERASE - remove data and partition table only. Data may still be recoverable using special software.
 - Full ERASE - HDD duplicator sends a WIPE command to the hard drive. This command fills 00 string to entire HDD
 - DoD ERASE - overwrites a string of pattern over the entire disk three times according to DoD 5220.22-M sanitizing standard
- LCM control module provides a rich set of robust advanced configuration options (click Full LCD console feature list to see a complete list of this duplicator functions)
- Operate as a stand-alone appliance. No computer or software needed
- Optional adapters for duplicating the following flash media: CFast card, CF card, slim SATA SSD, 1.8" micro SATA HDD/SSD

Note

* The speed here is for reference only. The speed were measured basing on using high performance mSATA SSD for both source and target. The transfer rate varies depending on the speed of the source and destination drive

¹ There are three types of M2 SSD: M2 SATA SSD, M2 PCIe SSD and M2 NVMe SSD. M2 SATA SSD uses SATA interface, the same interface on SATA hard drive, and is the only type of M2 media supported by this duplicator.

SPECIFICATIONS

- Writing mode : Sector to Sector
- Maximum copying speed up to 260MB/sec. Actual speed varies depending on the drive performance
- Connectors on back of unit:
 - 2 eSATA ports for daisy chaining - 1 for upstream and 1 for downstream
 - Power cord input socket
- Can be daisy chained with any Jasper II duplicator to increase targets up to 255 maximum
- Powerful 32-bit CRC checksum to assure data integrity
- Sturdy metal frame construction
- Four (4) Snap-In drive bay for easy drive insertion or removal with no special tool
- LCD display with functional control panel
- Well ventilated for efficient air flow.
- Low noise high CFM ball bearing cooling fan
- Integrated 340W 110/240 auto-sense power supply
- Dimensions (W x D x H): 7.48 x 10.63 x 6.5 inch (190 x 270 x 16.5 mm)
- Weight: ~ 9.38 lb (5.25 Kg)
- Operating temperature and humidity: 0 - 60-degree C, 15% - 90% RH
- Storage temperature and humidity: (- 20) - (65) degree C, 0% - 95% RH non-condensing