

## Default settings on the duplicator:

**Copy** – set to copy system and file. This is for drives that have the following file system: NTFS, FAT/16/32, eXFAT, HFS, EXT3/4 or XFS. For other file systems and boot drives, you may need to change the setting to WHOLE MEDIA

**Performance** – set to SPEED for best performance. May encountered compatibility issue with certain SSD. Should that occur, try to change the setting to BALANCE or COMPATIBILITY.

**HPA** – set to SKIP.

Please review the Jasper II Duplicator user guide for all the detail settings.

## Making duplicates

Power up the unit by pressing on the ON/OFF button at the front lower right hand corner. Once the unit is ready, the LCD should display

### HDD Duplicator

#### 1. Copy

The unit is now ready. Simply load a source drive to the source slot (the first bay on the top) and up to three target drives to the target slots (the three lower bays). After a few seconds, the LCD should display the number of target drives detected. Press the OK button on the LCM control panel to start the copying.

Note: some drives may not be detected correctly. In that case, please leave the drive inside the unit and re-starting the duplicator.

**Addonics**  
TECHNOLOGIES

# User Guide



## Jasper II 11M – 1:11 M2/mSATA/2.5” HDD/SSD High Speed duplicator

Model: JD2-11M

## CONTACT US

**www.addonics.com**

**Phone:** 408-573-8580

**Fax:** 408-573-8588

**Email:** <http://www.addonics.com/sales/query/>

### Technical Support

If you need any assistance to get your unit functioning properly, please have your product information ready and contact Addonics Technical Support at:

**Hours:** 8:30 am - 6:00 pm PST

**Phone:** 408-453-6212

**Email:** <http://www.addonics.com/support/query/>

## Overview



## Rear view

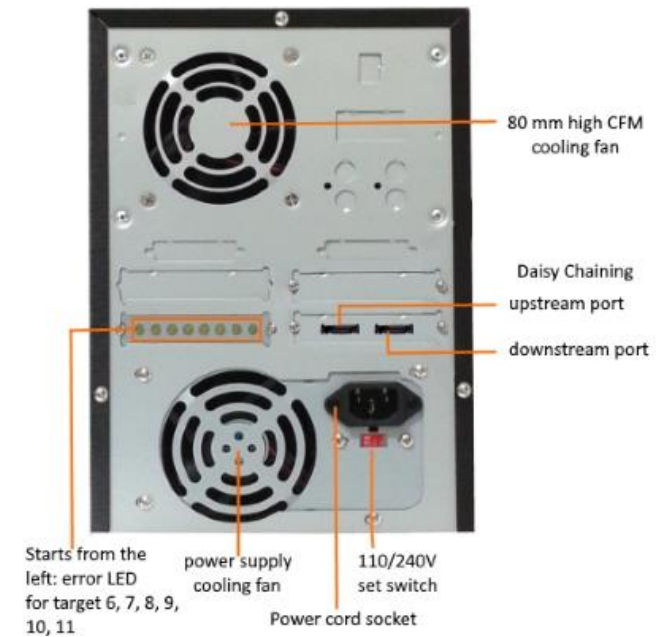

### M2 SSD installation

1. insert the M2 SSD into the M2 socket at ~ 30 degree angle
2. push down on the M2 SSD till it lays flat on the PCB

3. turn the M2 hold down lever to over the top of the M2 SSD

### mSATA SSD installation

1. insert the mSATA SSD into the mSATA connector at ~ 30 degree angle
2. push down the mSATA SSD onto the PCB till the media is latched securely by the hold down clip

#### WARNING

Be sure to set the 110/240V switch to the correct setting to your local outlet before powering on the unit. Wrong setting may cause damage to the power supply

#### Package content:

- Jasper II 1:11 2.5" duplicator main unit
- Twelve (12) units of 2.5" M2/mSATA flash drive adapter (model: AD25M2MSA)
- One power cord
- One 3-foot eSATA cable (use for daisy chaining to another Jasper II duplicator)
- This quick start user guide for Jasper II 3M
- Jasper II duplicator user guide